



# Meetings and Events

at the Radisson Edwardian Manchester, Free Trade Hall

Our experience creates a better experience

**Radisson**<sup>®</sup>  
**EDWARDIAN**  
MANCHESTER



## Meetings and events should always be this easy

- Meeting spaces where everything you need is close by
- Event Managers at your service from your first enquiry to the moment you leave
- Complimentary wi-fi
- Food that's fast, fresh and sourced locally
- Sensible pricing without the hidden extras
- All-inclusive small meeting packages
- Loyalty rewarded with Points for Planners [radissonedwardian.com/pointsforplanners](http://radissonedwardian.com/pointsforplanners)

### Meet Well

Meeting well means treating well the things that really matter. More than just reducing your meeting's environmental impact, it's also a commitment to positively affecting the communities we are a part of. Our approach to responsible business means a clearer conscience for you – whatever the size and style of your event.

Visit [radissonedwardian.com/meetwell](http://radissonedwardian.com/meetwell)

They came to debate.  
Now you can do business!



In Manchester's most celebrated building, the Free Trade Hall, stylish spaces create a mood of understated luxury just moments from Manchester Central. 22 flexible meeting rooms host events for up to 500. Sienna Spa, deep in the building's vaults, is a blissful urban hideaway, and Opus One bar and restaurant showcases the season's best British ingredients. Through the hotel's soaring lobby, Alto is a relaxed alternative for dress-down dining all day.



Walters Suite



Pennine Suite



The Colonnade

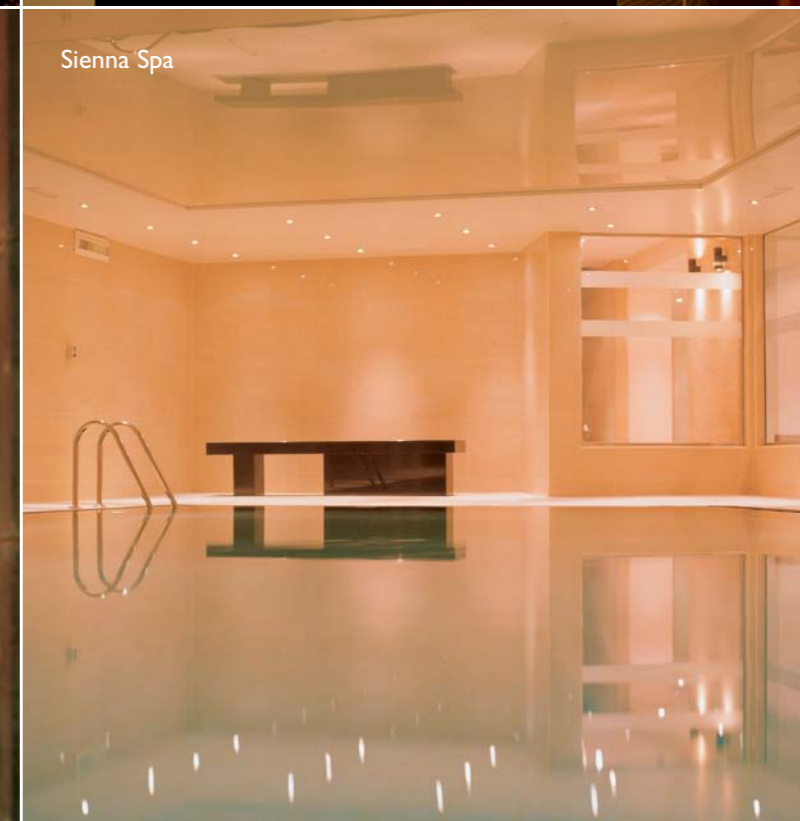

Sienna Spa



England's North West Tourist Awards 2010  
- Winner for Best Large North West Hotel.



enjoyEngland®  
Awards for  
Excellence 2011  
SILVER WINNER

Buffet



## Thought for food

There's truth in the old adage that you are what you eat, so it's reassuring to know that considerable thought has gone into preparing it.

Alto bar and restaurant



Opus One bar and restaurant



A mid-morning energy boost, lunch to linger over and a well timed afternoon pick-me-up – it's all freshly prepared and nutritionally balanced to help you stay sharp throughout the day, because the food you eat fuels your success. Select a bespoke menu tailored to your needs.



# Capacity



	Theatre	Classroom	Boardroom	U-shape	Cabaret	Reception	Lunch/Dinner
Halle Suite	400	180	80	90	180	500	280
Richter	120	50	30	30	54	100	80
Beecham	60	24	20	–	24	50	30
Harty	60	24	20	–	24	50	30
Barbirolli	120	50	30	30	54	125	80
Walters Suite	80	50	32	36	50	70	70
Peterloo	–	–	16	–	–	–	16
Hunt	–	–	16	–	–	–	16
Bamford	–	–	16	–	–	–	16
Cobden	–	–	12	–	–	–	–
Bright	–	–	12	–	–	–	–
Villiers	–	–	12	–	–	–	–
Peel	30	16	16	20	12	30	20
Disraeli	30	16	16	20	12	30	20
Gladstone	30	16	14	14	12	30	20
Dickens/Thackeray	80	40	36	30	36	60	60
Dickens	50	30	16	18	18	30	30
Thackeray	30	16	14	12	12	20	20
Pankhurst	60	24	36	–	18	80	40
Stanley/Livingstone	100	50	40	36	54	80	80
Stanley	50	26	20	20	24	40	40
Livingstone	40	18	14	14	12	20	20
Kenney	–	9	10	–	–	–	10
Mursell	–	9	10	–	–	–	10
Collier	–	9	10	–	–	–	10

# Floor Dimensions

	Area	Length m (ft)	Width m (ft)	Height m (ft)	Floor	Natural daylight
Halle Suite	357 m <sup>2</sup> (3843 ft <sup>2</sup> )	27.5m (90'3")	13m (42'8")	3.6m (11'10")	2	✓
Richter	105 m <sup>2</sup> (1130 ft <sup>2</sup> )	8.1m (26'7")	13m (42'8")	3.6m (11'10")	2	✓
Beecham	62 m <sup>2</sup> (667 ft <sup>2</sup> )	4.8m (15'9")	13m (42'8")	3.6m (11'10")	2	✓
Harty	62 m <sup>2</sup> (667 ft <sup>2</sup> )	4.8m (15'9")	13m (42'8")	3.6m (11'10")	2	✓
Barbirolli	127 m <sup>2</sup> (1367 ft <sup>2</sup> )	9.8m (32'2")	13m (42'8")	3.6m (11'10")	2	✓
Walters Suite	36 m <sup>2</sup> (387 ft <sup>2</sup> )	11.6m (38')	3.6m (11'10")	2.1m (6'11")	1	✓
Peterloo	34 m <sup>2</sup> (36 ft <sup>2</sup> )	7.6m (24'11")	4.5m (14'9")	2.1m (6'11")	1	✓
Hunt	34 m <sup>2</sup> (366 ft <sup>2</sup> )	7.6m (24'11")	4.5m (14'9")	2.1m (6'11")	1	✓
Bamford	34 m <sup>2</sup> (366 ft <sup>2</sup> )	7.6m (24'11")	4.5m (14'9")	2.1m (6'11")	1	✓
Cobden	24 m <sup>2</sup> (258 ft <sup>2</sup> )	6.8m (22'4")	3.6m (11'10")	2.1m (6'11")	1	✓
Bright	24 m <sup>2</sup> (258 ft <sup>2</sup> )	6.8m (22'4")	3.6m (11'10")	2.1m (6'11")	1	✓
Villiers	24 m <sup>2</sup> (258 ft <sup>2</sup> )	6.8m (22'4")	3.6m (11'10")	2.1m (6'11")	1	✓
Peel	36 m <sup>2</sup> (387 ft <sup>2</sup> )	8m (26'3")	4.6m (15'1")	2.25m (7'5")	3	✓
Disraeli	36 m <sup>2</sup> (387 ft <sup>2</sup> )	8m (26'3")	4.6m (15'1")	2.25m (7'5")	3	✓
Gladstone	39 m <sup>2</sup> (420 ft <sup>2</sup> )	6.5m (21'4")	6.1m (20')	2.25m (7'5")	3	✓
Dickens/Thackeray	106 m <sup>2</sup> (1141 ft <sup>2</sup> )	1.4m (45'11")	7.6m (24'11")	2.25m (7'5")	4	–
Dickens	62 m <sup>2</sup> (7 ft <sup>2</sup> )	8.2m (26'11")	7.6m (24'11")	2.25m (7'5")	4	–
Thackeray	44 m <sup>2</sup> (473 ft <sup>2</sup> )	5.8m (19')	7.6m (24'11")	2.25m (7'5")	4	–
Pankhurst	88 m <sup>2</sup> (947 ft <sup>2</sup> )	14.7m (48'3")	6.m (19'8")	2.25m (7'5")	4	–
Stanley/Livingstone	125 m <sup>2</sup> (1345 ft <sup>2</sup> )	13.6m (44'7")	9.2m (30'2")	2.25m (7'5")	4	–
Stanley	74 m <sup>2</sup> (796 ft <sup>2</sup> )	7.8m (25'7")	9.6m (31'6")	2.25m (7'5")	4	–
Livingstone	53 m <sup>2</sup> (570 ft <sup>2</sup> )	5.8m (19')	9.2m (30'2")	2.25m (7'5")	4	–
Kenney	28 m <sup>2</sup> (301 ft <sup>2</sup> )	4.8m (15'9")	6m (19'8")	2.1m (6'11")	4	–
Mursell	26 m <sup>2</sup> (279 ft <sup>2</sup> )	4.8m (15'9")	5.6m (18'4")	2.1m (6'11")	4	–
Collier	26 m <sup>2</sup> (279 ft <sup>2</sup> )	4.8m (15'9")	5.6m (18'4")	2.1m (6'11")	4	–

# First Floor

All meeting rooms are fully air conditioned and benefit from:

- Complimentary wireless
- Broadband access
- Dedicated audio-visual support
- LCD Projection Screens in all rooms
- Business centre with printing facilities and ATM machine

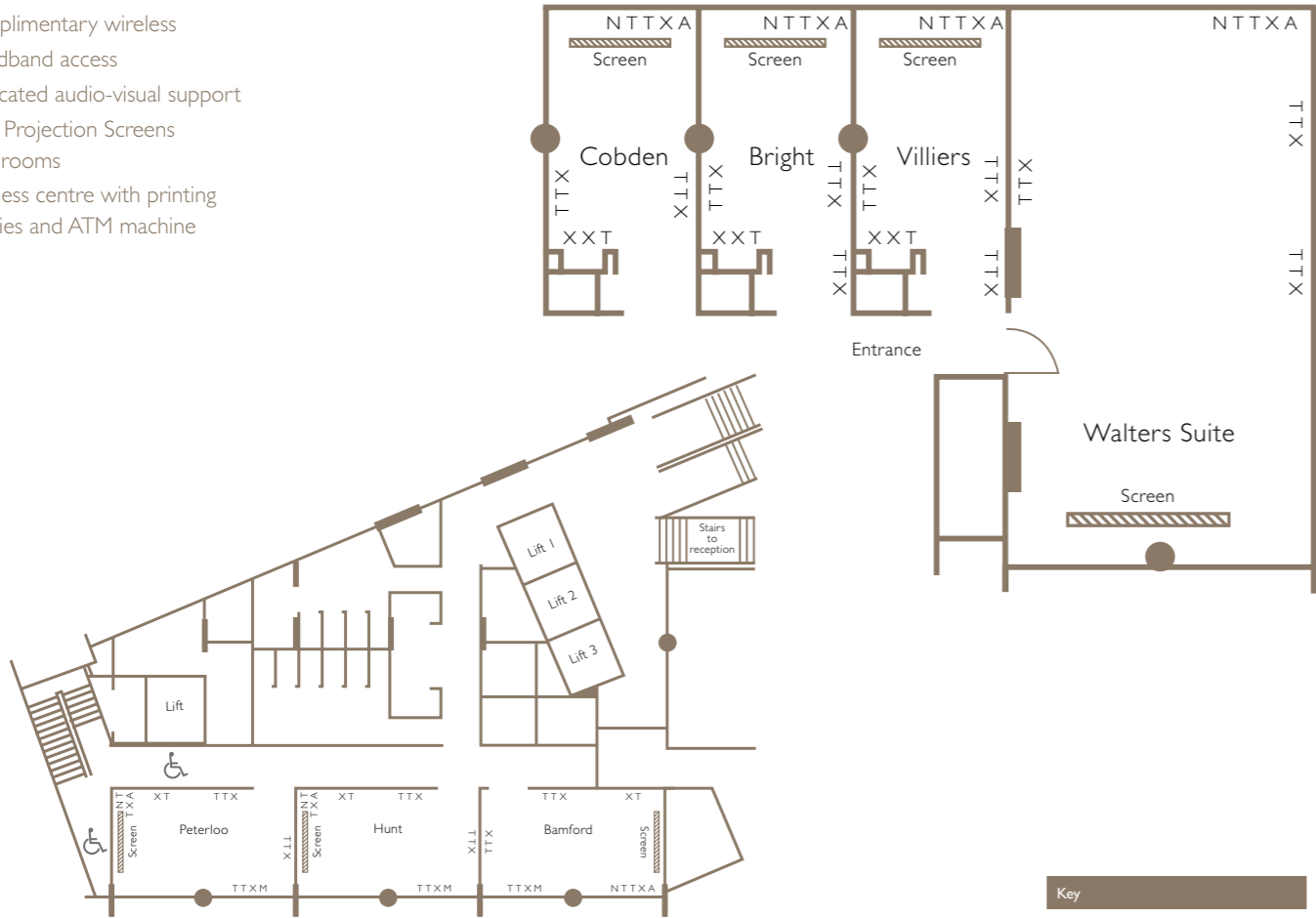

Key	
A	= TV aerial
N	= Network point
T	= Phone
X	= 13 amp socket
⊙	= 13 phase 63a supply
L	= Lighting control panel
▨	= Screen
▬	= TV Plasma
▤	= Partition

# Second Floor: Halle Conference Centre

Technical services: (available on request)

- Audio and visual
- Lighting and staging
- Laptops, macbooks and iPods
- Conference phones
- Lecterns
- Customised conference packages

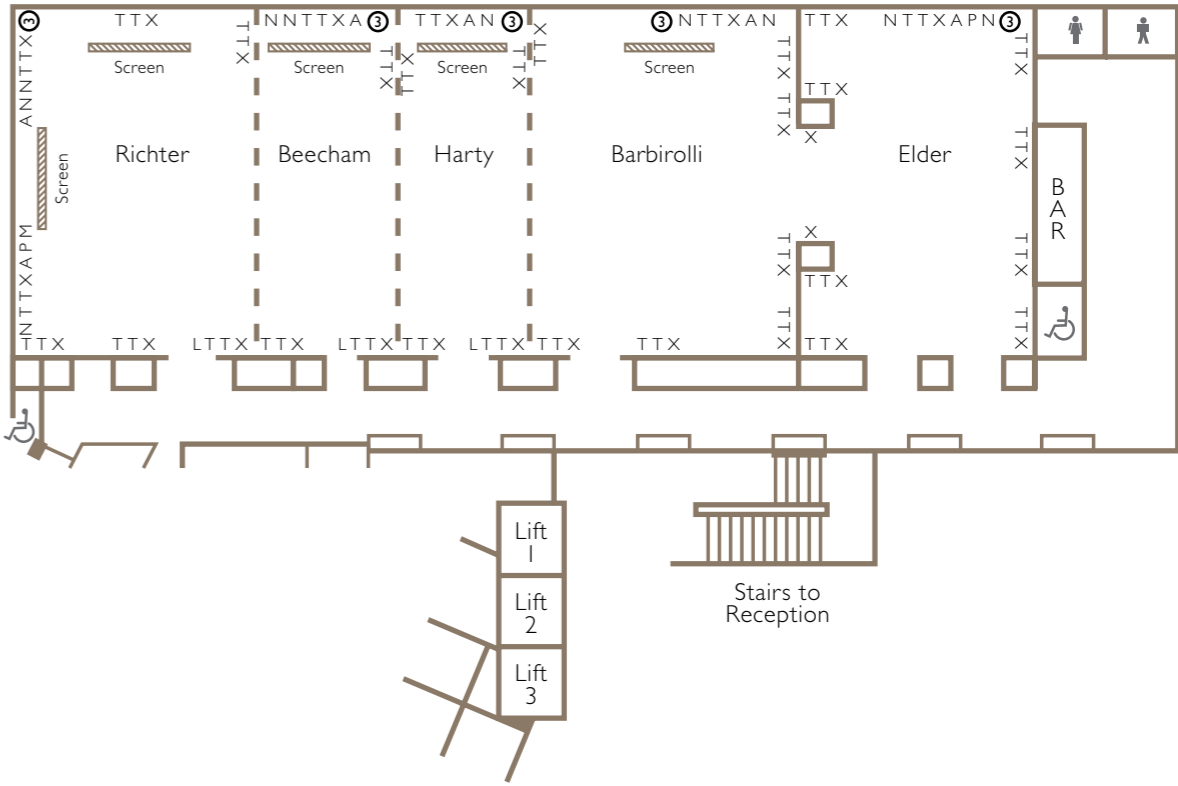

# Third Floor

# Fourth Floor

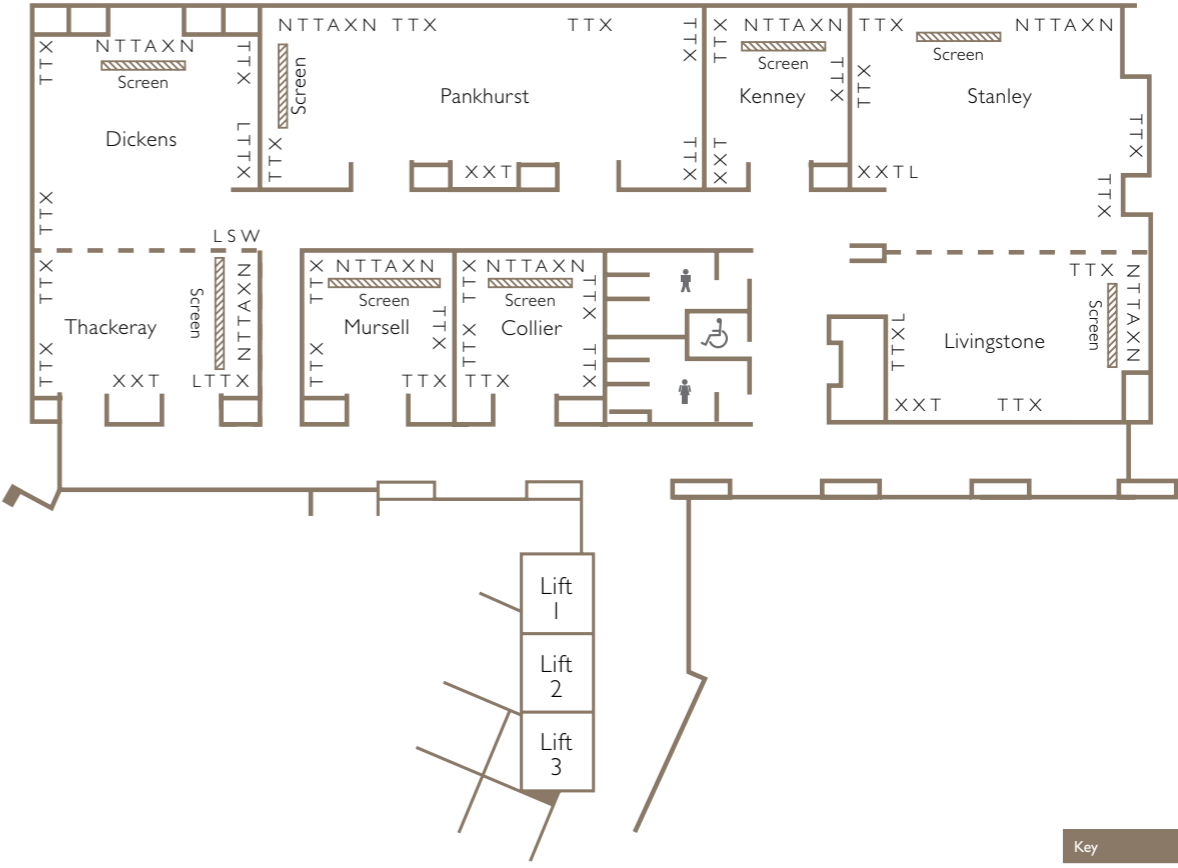
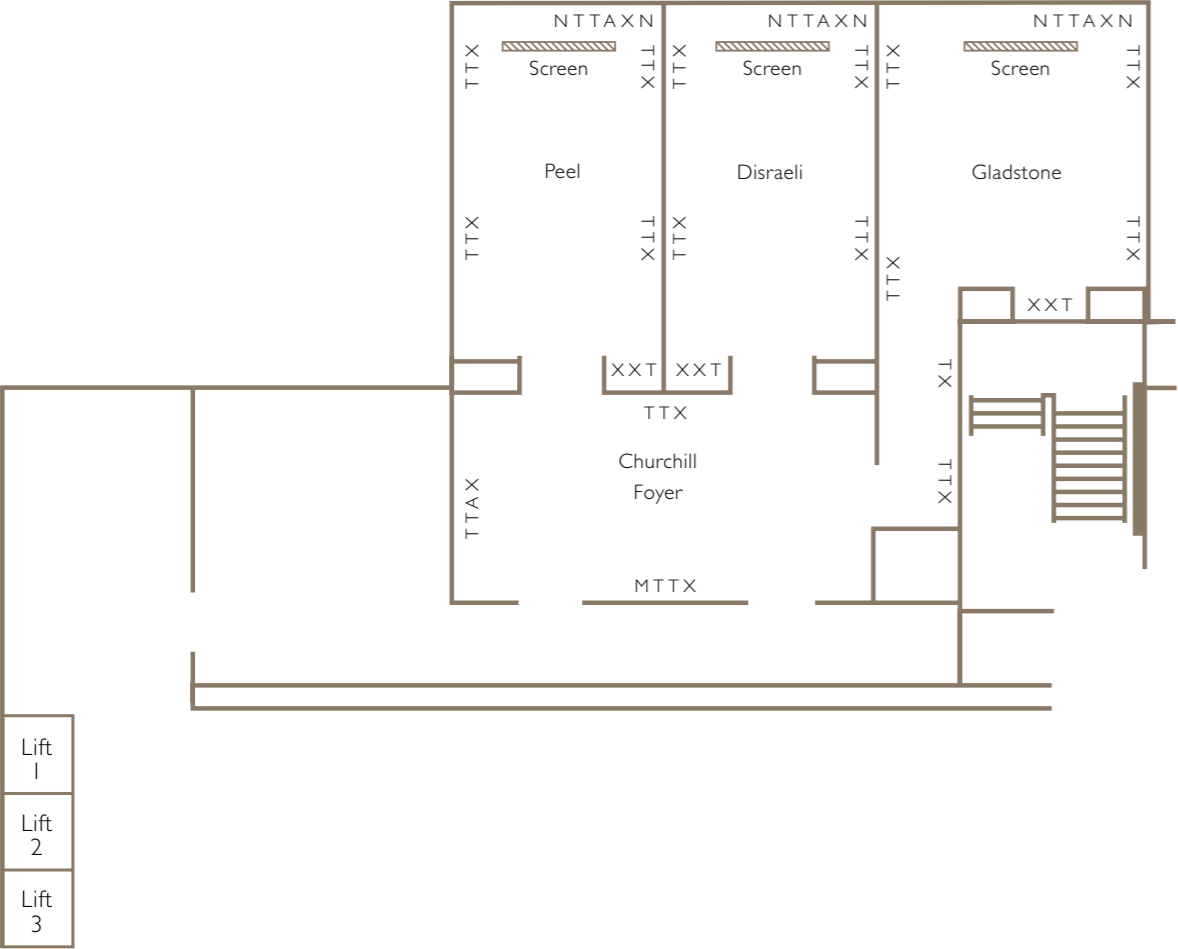

Key	
A	= TV aerial
N	= Network point
T	= Phone
X	= 13 amp socket
▨	= Screen
■	= Partition

Find us

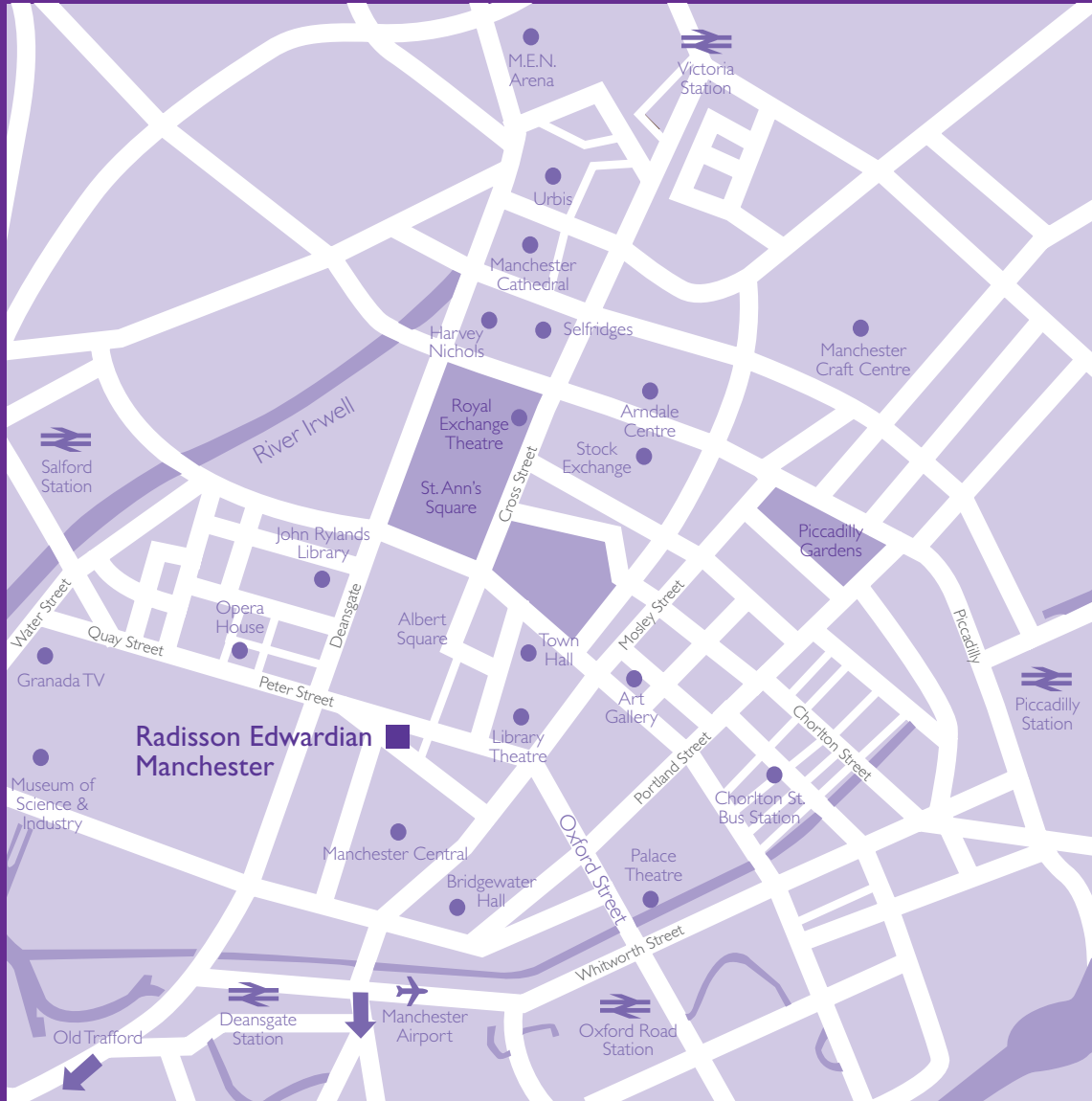

Radisson Edwardian Manchester ★★★★★ Free Trade Hall, Peter Street, Manchester M2 5GP  
t: +44 (0)161 835 9929 f: +44 (0)161 835 8937 e: rehmanchestermeetings@radisson.com  
[radissonedwardian.com/manchester](http://radissonedwardian.com/manchester)