

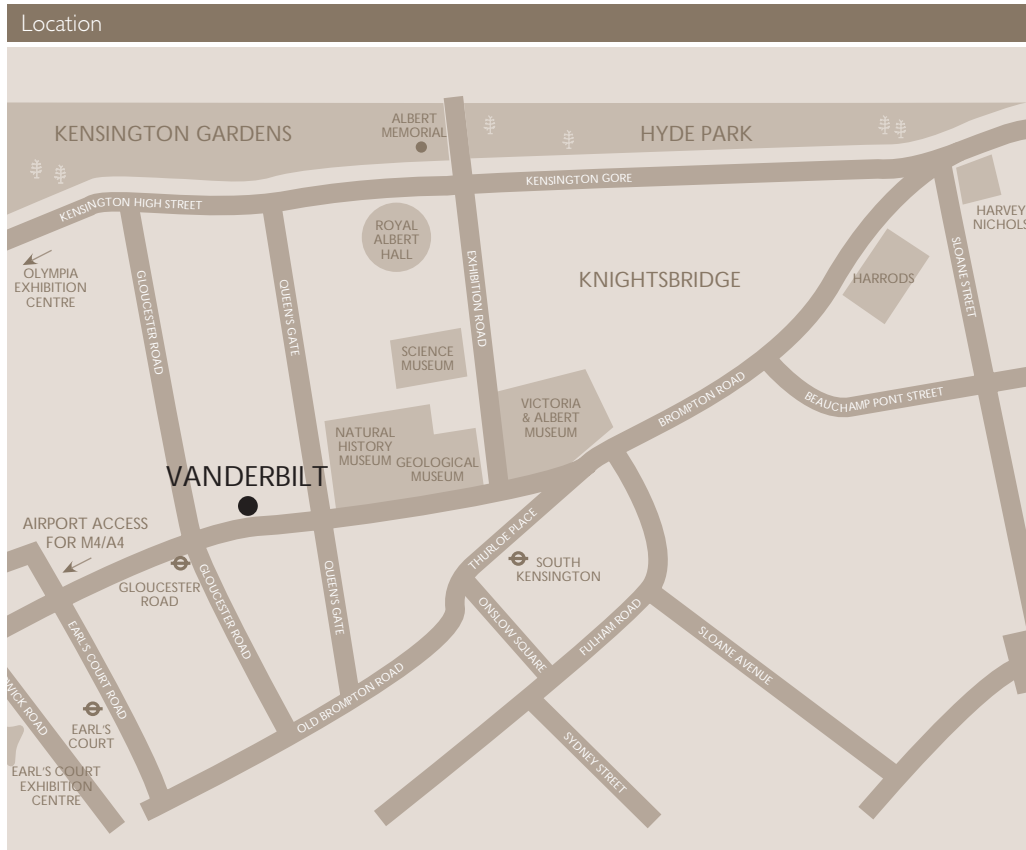

vanderbilt planning guide



This is a working document that gives you all the practical details, plans and space to make notes as you plan for your event. It also makes it easy to discuss your event accurately over the telephone. We hope you find it valuable.

Accommodation

215 bedrooms:
 1 Suite; 20 Kings; 5 Triples;
 65 Doubles; 63 Twins; 61 Singles;
 4 floors; 2 lifts accessing all floors

Dining

68-86 bar & restaurant

Conference and private dining

Maximum capacity: 100
 Nearest underground station:
 Gloucester Road; District Line, Circle Line and Piccadilly Line

Facilities

Air-conditioning
 Express check out
 In-room safe
 Mini bar
 Mobile phone hire available
 Modem access
 Personal phone number with voicemail
 Satellite and pay movies

Nearest car park

☑ Valet parking only - Call hotel concierge for further details

Airports

	approx miles	approx minutes
Gatwick	34	60
Heathrow	12	30
London City	12	40
Luton	34	50
Stansted	40	60

Hotel services

Business centre. Fitness centre
 Concierge can arrange sightseeing tours; theatre and concert tickets; flowers; car hire.
 Babysitting available on request.
 Valet service available for laundry.

For places of interest please refer to map.

Contact information

Radisson Edwardian Vanderbilt Hotel ★★★★★
 68-86 Cromwell Road
 London SW7 5BT
 Telephone: +44 (0)20 7761 9000
 Facsimile: +44 (0)20 7761 9001
 Email: resvand@radisson.com

Conference & private dining
 Telephone: +44 (0)20 7761 9013
 Facsimile: +44 (0)20 7761 9003
 Email: vandcb@radisson.com
 www.radissonedwardian.com

Ground Floor

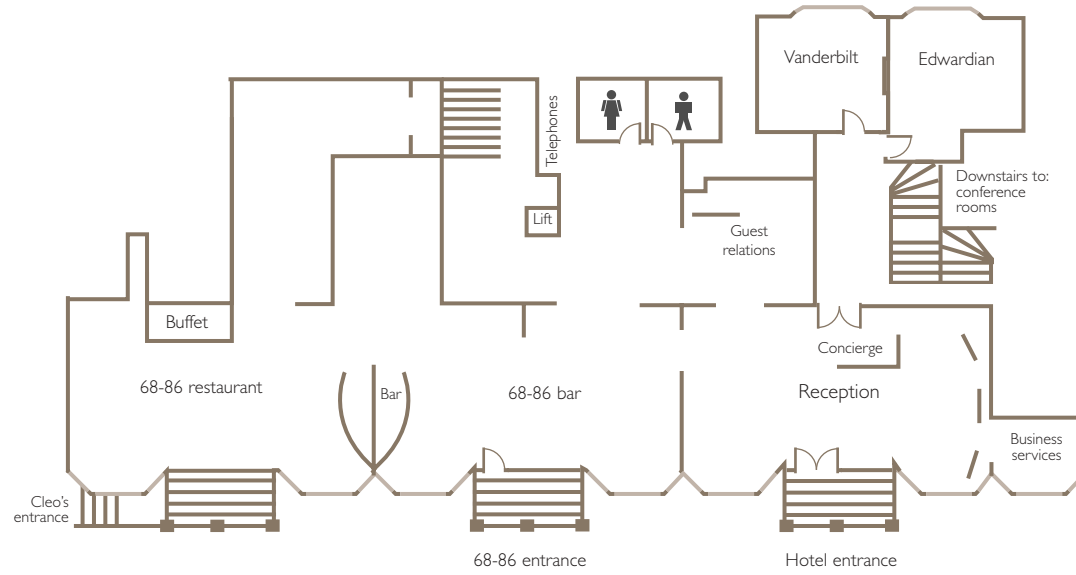

Lower Ground Floor

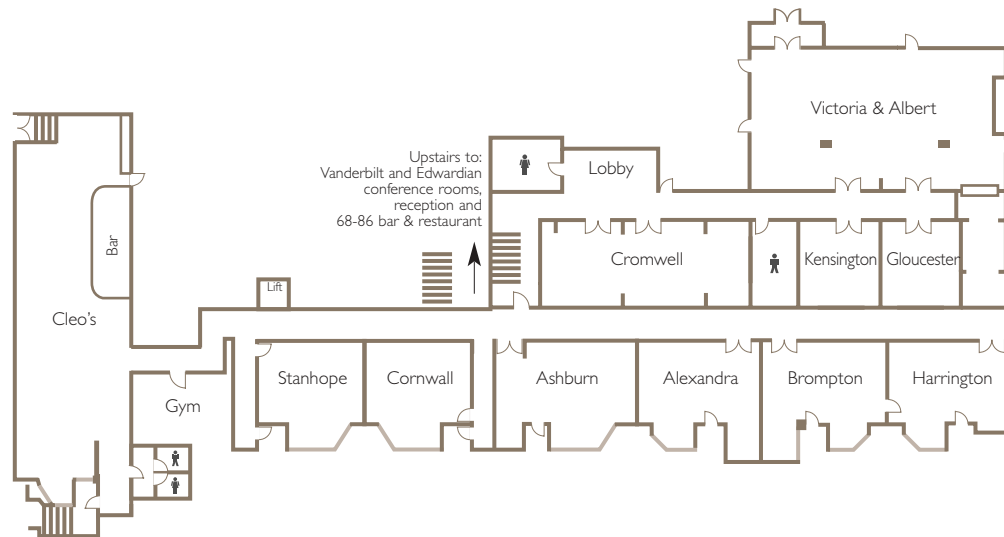

Key	
T	Telephone
X	13 amp socket
A	TV aerial
■	Pillar
—	Windows
▨	Screen
Ⓜ	3 phase - 13a

Ground Floor

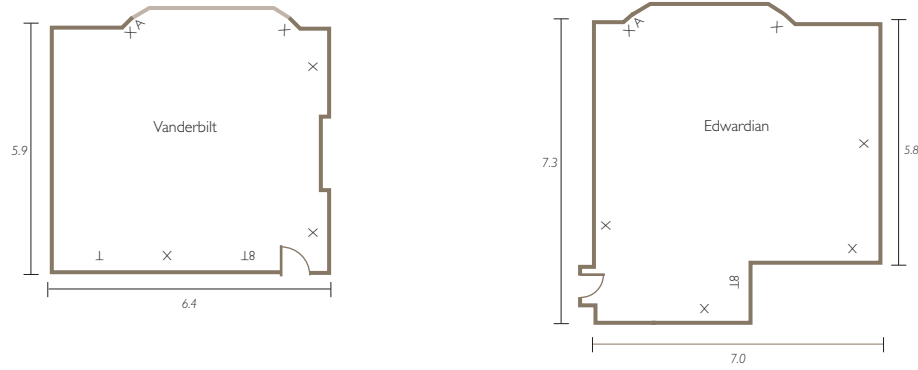

Lower Ground Floor

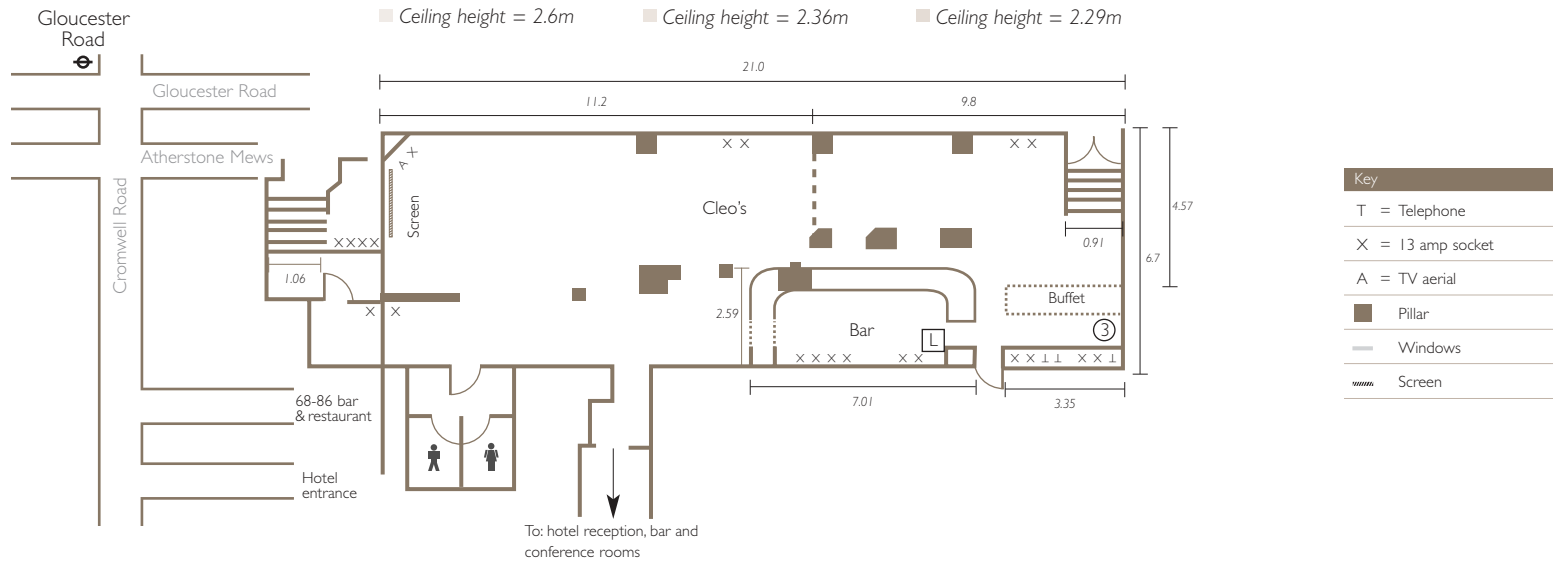

Lower Ground Floor

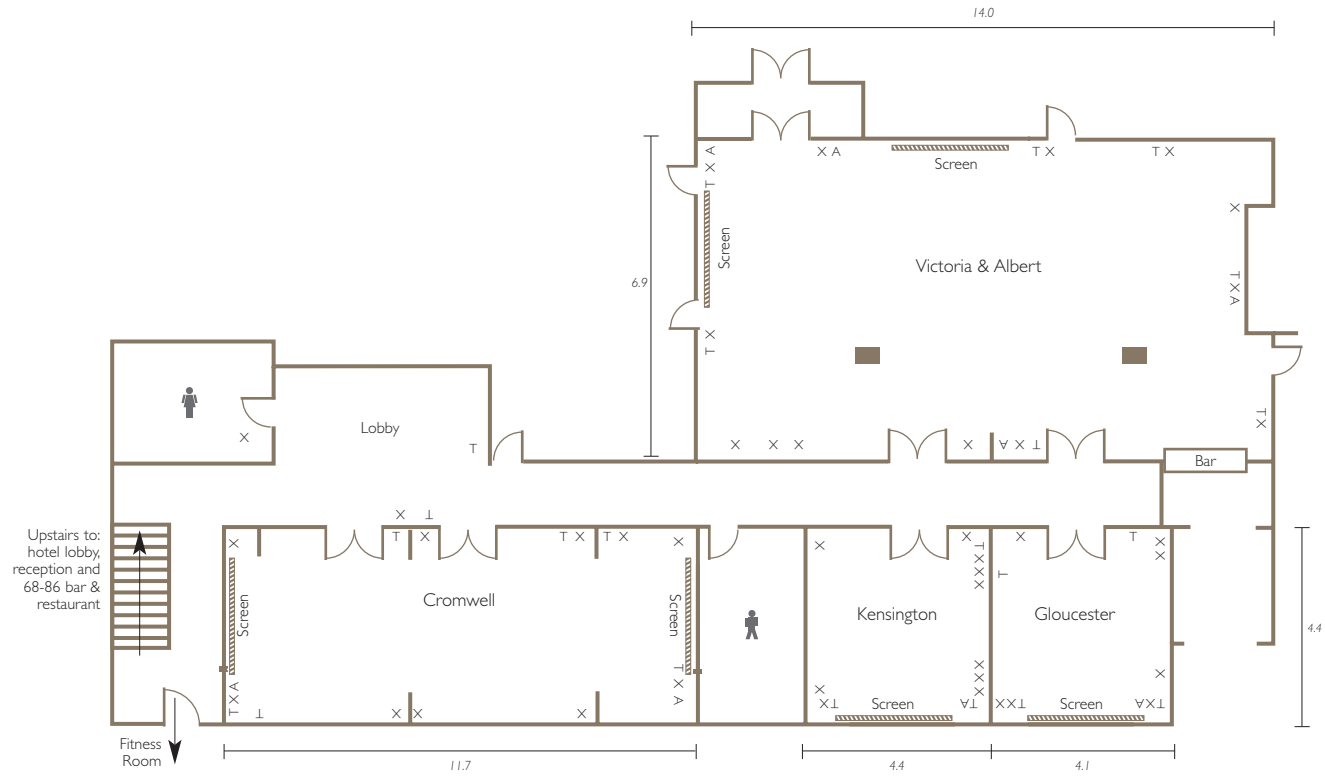

Lower Ground Floor

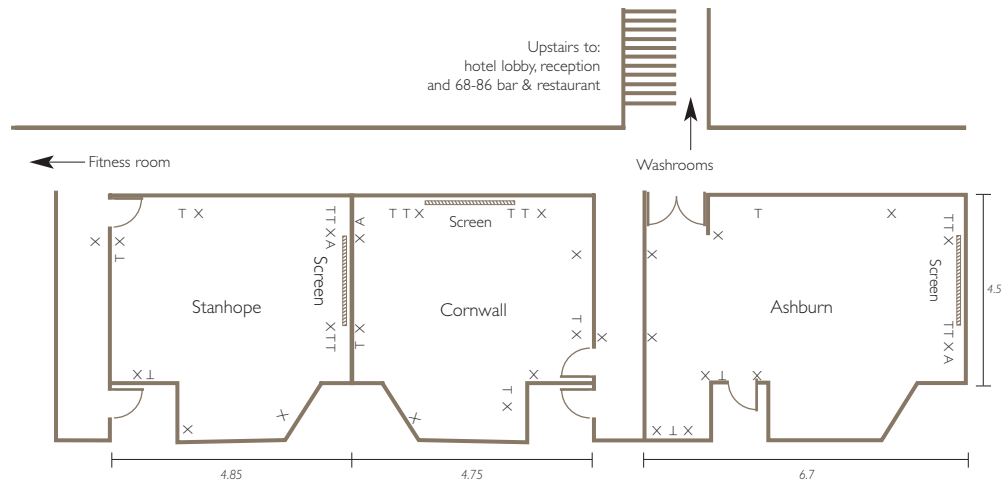
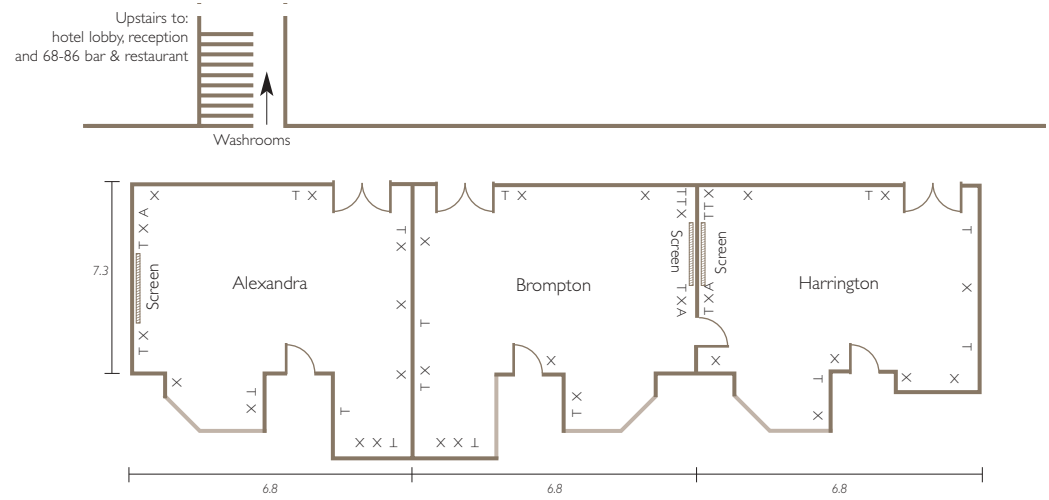

Guideline capacities

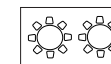
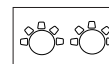
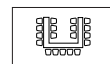
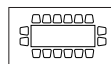
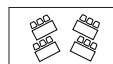

Function suites & rooms	Theatre	Classroom	Boardroom	U-shape	Cabaret	Reception	Lunch/dinner	Dinner dance
Cleo's	60	30	30	24	25	100	90	50
Victoria & Albert	100	50	40	35	40	140	90	70
Cromwell	40	24	24	20	24	50	50	–
Kensington	–	–	8	–	–	–	–	–
Gloucester	–	–	8	–	–	–	–	–
Vanderbilt	–	–	12	–	–	–	12	–
Edwardian	40	25	20	16	24	60	50	–
Alexandra	25	15	16	14	–	40	16	–
Brompton	25	15	16	14	–	40	16	–
Harrington	25	15	16	14	–	40	16	–
Stanhope	18	12	12	10	–	20	10	–
Cornwall	18	12	12	10	–	20	10	–
Ashburn	24	12	12	10	–	20	10	–

Dimensions & access

Details and measurements	Length m	Width m	Ceiling height m	Area square m	No. 13amp sockets	Phone points	Delegate access	Access door size h x w m	Air Con.	Natural daylight
Cleo's	21.0	6.7	2.6	75	21	3	Stairs	0.75 x 2.03	✓	✓
Victoria & Albert	14.0	6.9	2.4	96.6	13	7	Stairs	1.50 x 2.03	✓	–
Cromwell	11.7	4.4	2.4	51.5	9	7	Stairs	1.50 x 2.03	✓	–
Kensington	4.4	4.4	2.4	19.4	10	3	Stairs	1.50 x 2.03	✓	–
Gloucester	4.1	4.4	2.4	18.0	7	4	Stairs	1.50 x 2.03	✓	–
Vanderbilt	5.9	6.4	3.9	37.8	5	9	Lobby	1.50 x 2.03	✓	✓
Edwardian	7.0	7.3	3.9	51.1	8	8	Lobby	1.50 x 2.03	✓	✓
Alexandra	6.8	4.5	2.2	30.6	11	7	Stairs	1.50 x 2.03	✓	✓
Brompton	6.8	4.5	2.2	30.6	10	8	Stairs	1.50 x 2.03	✓	✓
Harrington	6.8	4.5	2.2	30.6	10	7	Stairs	1.50 x 2.03	✓	✓
Stanhope	4.8	4.5	2.4	21.6	7	7	Stairs	0.75 x 2.03	✓	✓
Cornwall	4.7	4.5	2.4	21.1	9	7	Stairs	0.75 x 2.03	✓	✓
Ashburn	6.7	4.5	2.4	30.1	10	7	Stairs	1.50 x 2.03	✓	✓



For information and bookings call:

London

T +44 (0)20 7845 8680

F +44 (0)20 7845 8681

E londonmeetings@radisson.com

Manchester

T +44 (0)161 835 9929

F +44 (0)161 835 9979

E rehmanchestermeetings@radisson.com

Heathrow

T +44 (0)20 8757 7903

F +44 (0)20 8757 7904

E htrwcb@radisson.com

or visit www.radissonedwardian.com