

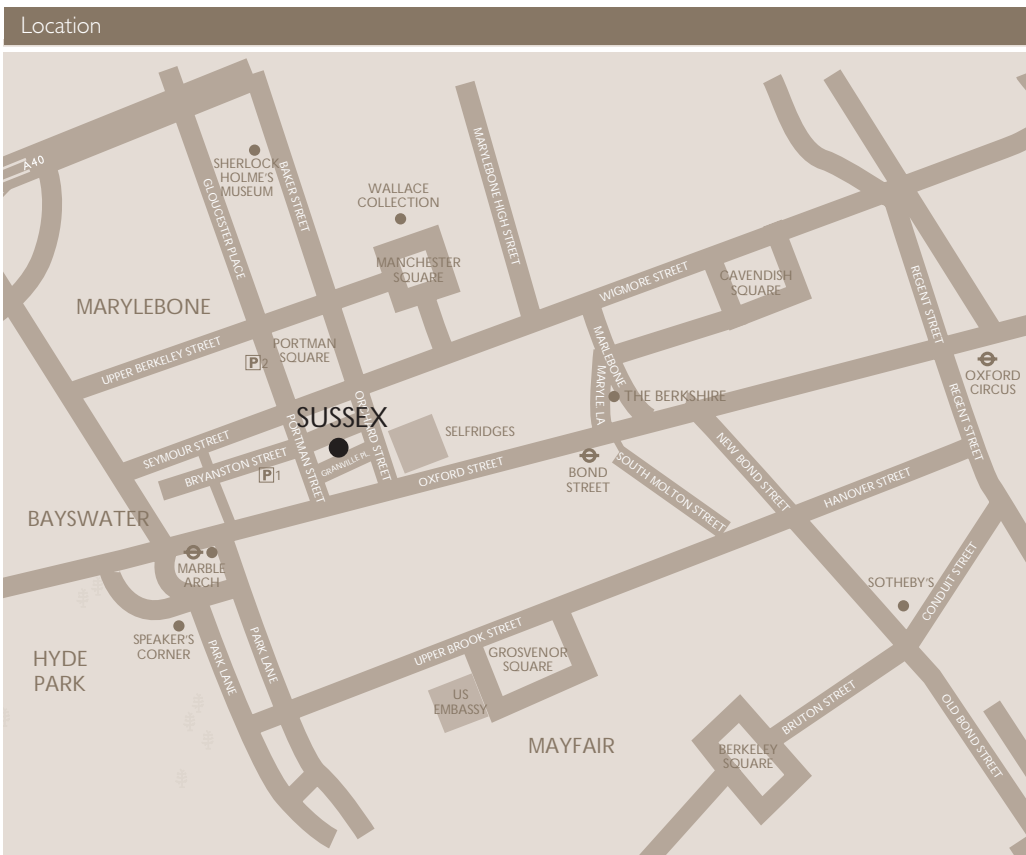

sussex planning guide



**Contact information ★★★★★**

**Radisson Edwardian Sussex Hotel ★★★★★**  
 19-25 Granville Place  
 London W1H 6PA  
 Telephone: +44 (0)20 7408 0130  
 Facsimile: +44 (0)20 7493 2070  
 Email: [ressuss@radisson.com](mailto:ressuss@radisson.com)

Conference & private dining  
 Telephone: +44 (0)20 7845 8680  
 Facsimile: +44 (0)20 7845 8681  
 Email: [sussexcb@radisson.com](mailto:sussexcb@radisson.com)  
[www.radissonedwardian.com](http://www.radissonedwardian.com)

This is a working document that gives you all the practical details, plans and space to make notes as you plan for your event. It also makes it easy to discuss your event accurately over the telephone. We hope you find it valuable.

**Accommodation**

101 bedrooms:  
 24 Kings; 24 Doubles; 15 Twins;  
 8 Family rooms; 30 Singles

**Facilities**

- Air conditioning
- Broadband internet access
- B&O televisions
- Express check out
- In-room safe
- ISDN connection
- Minibar
- Mobile phone hire available
- Personal phone number with voicemail
- Personalised viewing/listening – films and music
- Trouser press

Meeting rooms & private dining  
 Two meeting rooms  
 Maximum capacity: 12

**Hotel services**

Fully equipped fitness room. State of the art business centre. Concierge can arrange sightseeing tours; theatre and concert tickets; flowers; car hire. Babysitting available on request.

**Dining**

Nova bar & grill

**Nearest underground station**

Marble Arch; Central Line  
 Bond Street; Central Line and Jubilee Line

**Nearest car park**





- P** 1 Bryanston Street
  - P** 2 Portman Square
- Both open 24 hours 7 days a week

**Airports**

	approx miles	approx minutes
Gatwick	37	60
Heathrow	18	30
London City	11	40
Luton	33	40
Stansted	38	60

For places of interest please refer to map.

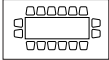
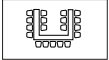
Guideline capacities

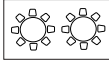
								
Function suites & rooms	Theatre	Classroom	Boardroom	U-shape	Cabaret	Reception	Lunch/dinner	Dinner dance
The Red Room	-	-	4				4	
The Green Room	-	-	12				12	

Dimensions & access

Details and measurements	Length m	Width m	Ceiling height m	Area square m	No. 13amp sockets	Phone points	Delegate access	Access door size h x w m	Air Con.	Natural daylight
The Red Room	3.3	3.0	2.5	9.9	4	1	Lobby	2.0 x 0.75	✓	-
The Green Room	5.1	3.0	2.5	15.3	6	2	Lobby	2.0 x 0.75	✓	✓

Ground Floor

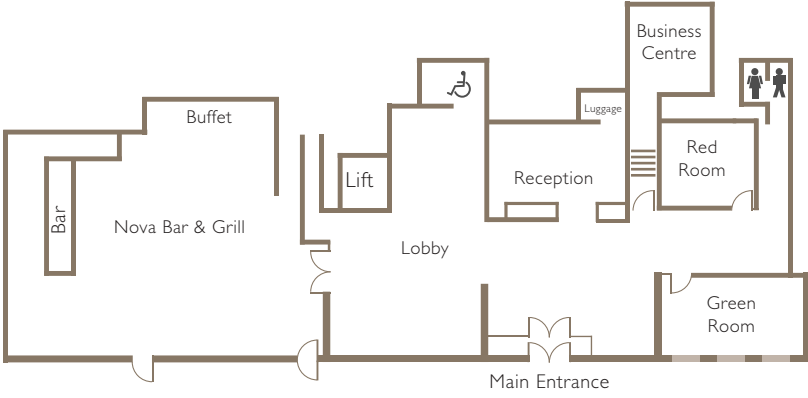



For information and bookings call:

London

T +44 (0)20 7845 8680

F +44 (0)20 7845 8681

E [londonmeetings@radisson.com](mailto:londonmeetings@radisson.com)

Manchester

T +44 (0)161 835 9929

F +44 (0)161 835 9979

E [rehmanchestermeetings@radisson.com](mailto:rehmanchestermeetings@radisson.com)

Heathrow

T +44 (0)20 8757 7903

F +44 (0)20 8757 7904

E [htrwcb@radisson.com](mailto:htrwcb@radisson.com)

or visit [www.radissonedwardian.com](http://www.radissonedwardian.com)