

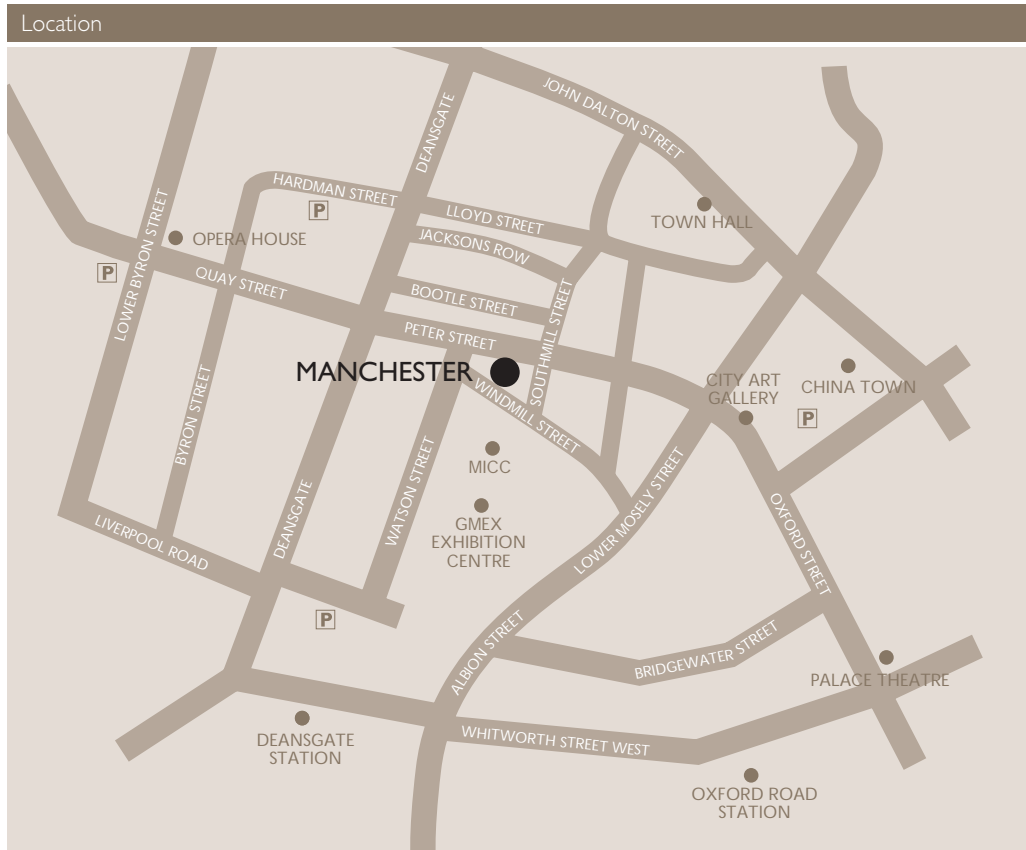

manchester planning guide

*Radisson*  
EDWARDIAN  
HOTELS



One of Manchester's new focal points – a luxury 21st century hotel on the site of the famous Free Trade Hall. Monumental listed frontage is combined with powerful new landmark architecture. The hotel is located in the middle of the breathtaking new conference quarter development right next to the GMEX Exhibition Centre and Manchester International Convention Centre (MICC).

Contemporary classic interior design is celebrated in 263 superb rooms, including 4 penthouse suites and 13 suites.

Purpose-designed meeting facilities with 21st century technology is evident in the 18 meeting rooms and two conference rooms which can combine into one major function suite capable of hosting up to 425 people.

The two restaurants and bars offer dining in chic classic contemporary surrounds, providing the perfect destination for social gatherings or business meetings.

**Contact information**

Radisson Edwardian Manchester ★★★★★  
 Peter Street  
 Manchester M2 5GP  
 Telephone: +44 (0)161 835 9929  
 Facsimile: +44 (0)161 835 9979

[www.radissonedwardian.com](http://www.radissonedwardian.com)

First Floor



Key	
A	: TV aerial
N	: Network point
T	: Phone
X	: 13a socket (double)
⊖	: 13 phase 63a supply
L	: Lighting Control Panel
////	: Screen
- - -	: Partition

First Floor

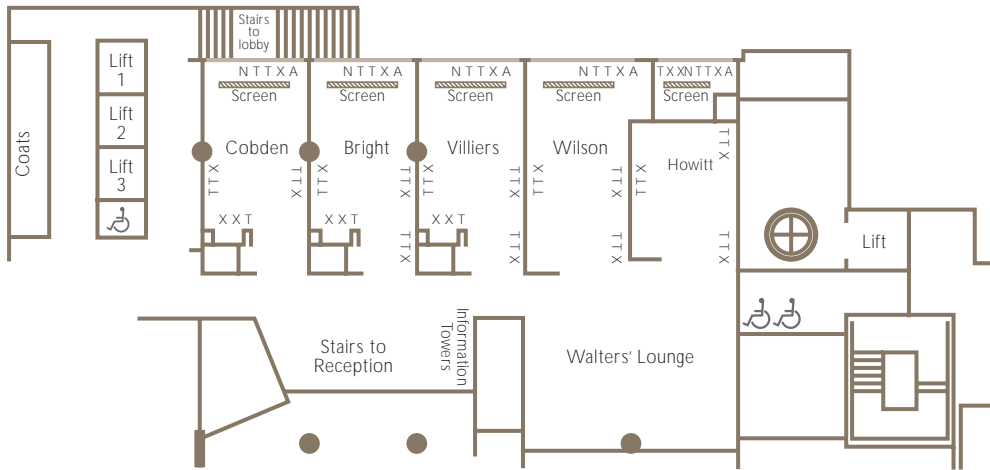

Second Floor: Hallé Conference Centre

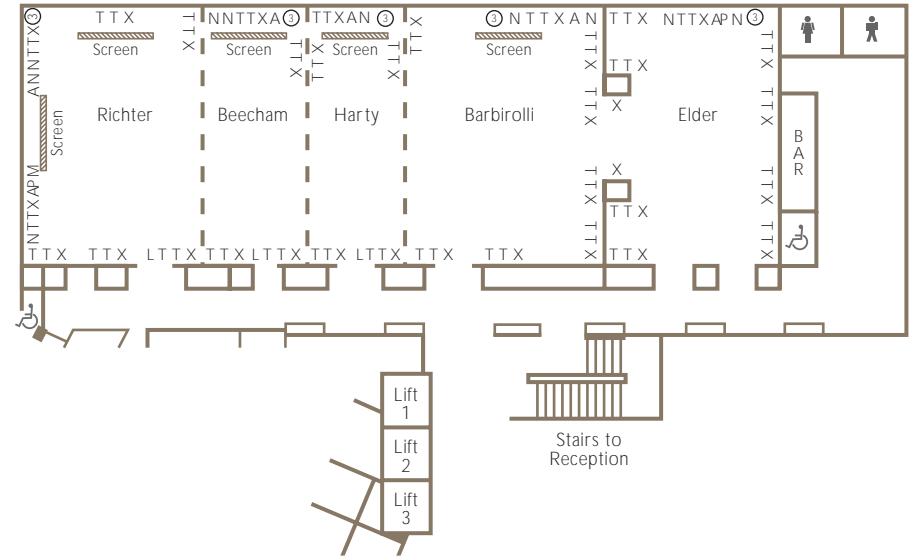

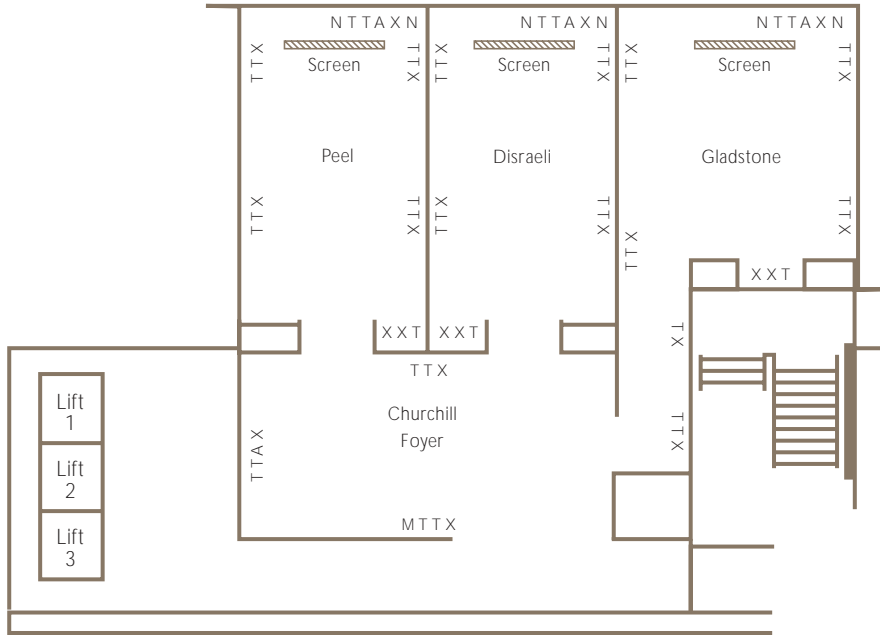

Third Floor

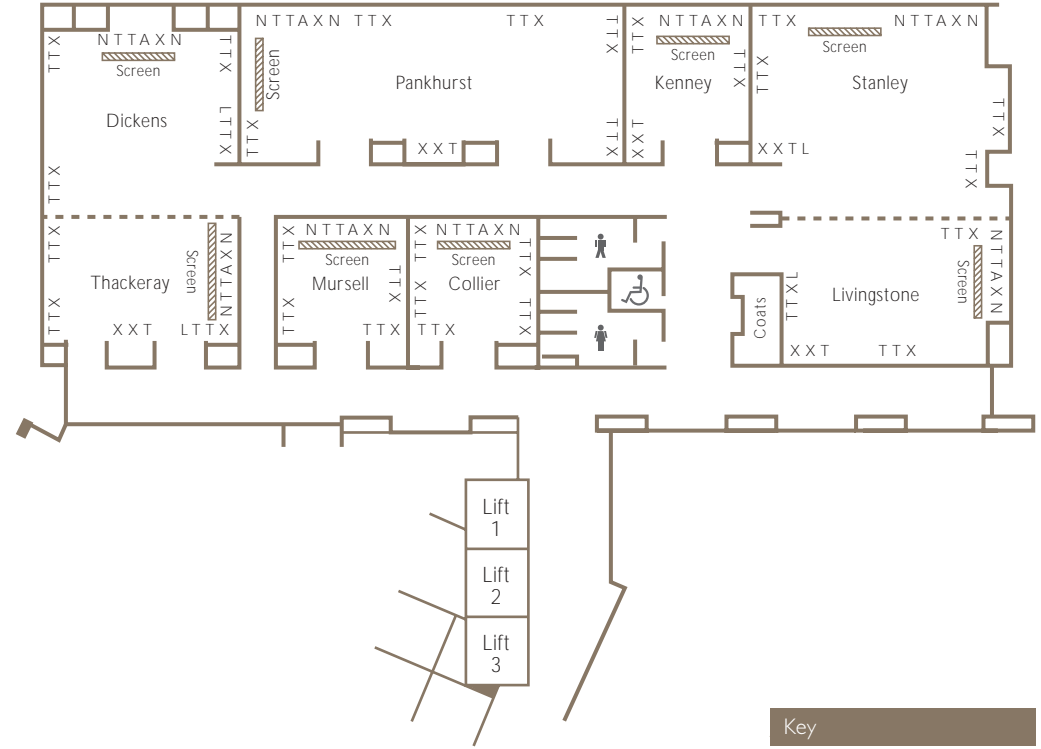

Fourth Floor



Key	
A	: TV aerial
N	: Network point
T	: Phone
X	: 13a socket (double)
	: Screen
	: Partition

## Guideline capacities

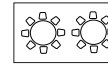
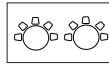
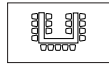
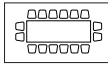
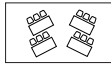

Function suites & rooms	Theatre	Classroom	Boardroom	U-shape	Cabaret	Reception	Lunch/dinner
Hallé Conference & Banqueting Suite	425	180	80	90	180	425	400
Richter	120	55	32	30	60	120	100
Beecham	60	30	24	20	30	50	50
Harty	60	30	24	20	30	50	50
Barbirolli	125	60	36	30	60	125	100
Elder							
Peterloo	24	12	14	12	0	25	14
Hunt	24	12	14	12	0	25	14
Bamford	24	12	14	12	0	25	14
Cobden	0	0	12	0	0	0	0
Bright	0	0	12	0	0	0	0
Villiers	0	0	12	0	0	0	0
Wilson	0	0	12	0	0	0	0
Howitt	0	0	8	0	0	0	0
Peel	30	16	16	14	15	30	16
Disraeli	30	16	16	14	15	30	16
Gladstone	30	16	14	14	15	30	14
Churchill Foyer							
Dickens/Thackeray	80	50	40	36	40	100	40
Dickens	50	30	24	20	25	50	40
Thackeray	30	20	16	14	15	30	20
Pankhurst	70	30	36	30	30	70	60
Stanley/Livingstone	50	50	50	36	45	110	40
Stanley	50	28	24	20	25	50	40
Livingstone	40	20	16	16	15	40	20
Kenney	16	0	10	10	0	0	10
Mursell	16	0	10	10	0	0	10
Collier	16	0	10	10	0	0	10

## Dimensions &amp; access

Suite	Length m	Width m	Ceiling height m	Area square m	Length ft/in.	Width ft/in	Ceiling height ft/in	Area sq ft	Floor	Delegate access	Access door	Air Con.	Natural daylight
Hallé Conference & Banqueting Suite	27.5	13	3.6	357	90 3	42 8	11 10	3843	2	Stairs/Lift	1.5	✓	✓
Richter	8.1	13	3.6	105	26 7	42 8	11 10	1130	2	Stairs/Lift	1.5	✓	✓
Beecham	4.8	13	3.6	62	15 9	42 8	11 10	667	2	Stairs/Lift	0.75	✓	✓
Harty	4.8	13	3.6	62	15 9	42 8	11 10	667	2	Stairs/Lift	1.5	✓	✓
Barbirolli	9.8	13	3.6	127	32 2	42 8	11 10	1367	2	Stairs/Lift	1.5	✓	✓
Elder (reception area)	8.5	13	2.25	110	27 11	42 8	7 5	1184	2	Stairs/Lift	1.5	✓	✓
Peterloo	7.6	4.5	2.1	34	24 11	14 9	6 11	366	1	Stairs/Lift	1.5	✓	✓
Hunt	7.6	4.5	2.1	34	24 11	14 9	6 11	366	1	Stairs/Lift	1.5	✓	✓
Bamford	7.6	4.5	2.1	34	24 11	14 9	6 11	366	1	Stairs/Lift	1.5	✓	✓
Cobden	6.8	3.6	2.1	24	22 4	11 10	6 11	258	1	Stairs/Lift	0.75	✓	✓
Bright	6.8	3.6	2.1	24	22 4	11 10	6 11	258	1	Stairs/Lift	0.75	✓	✓
Villiers	6.8	3.6	2.1	24	22 4	11 10	6 11	258	1	Stairs/Lift	0.75	✓	✓
Wilson	6.8	3.6	2.1	24	22 4	11 10	6 11	258	1	Stairs/Lift	1.5	✓	✓
Howitt	4.8	3.6	2.1	17	15 9	11 10	6 11	183	1	Stairs/Lift	1.5	✓	✓
Peel	8.0	4.6	2.25	36	26 3	15 1	7 5	387	3	Lift	1.5	✓	–
Disraeli	8.0	4.6	2.25	36	26 3	15 1	7 5	387	3	Lift	1.5	✓	–
Gladstone	6.5	6.1	2.25	39	21 4	20 0	7 5	420	3	Lift	1.5	✓	–
Churchill Foyer													
Dickens/Thackeray	14	7.6	2.25	106	45 11	24 11	7 5	1141	4	Lift	1.5	✓	–
Dickens	8.2	7.6	2.25	62	26 11	24 11	7 5	667	4	Lift	1.5	✓	–
Thackeray	5.8	7.6	2.25	44	19 0	24 11	7 5	473	4	Lift	1.5	✓	–
Pankhurst	14.7	6.0	2.25	88	48 3	19 8	7 5	947	4	Lift	1.5	✓	–
Stanley/Livingstone	13.6	9.2	2.25	125	44 7	30 2	7 5	1345	4	Lift	1.5	✓	–
Stanley	7.8	9.6	2.25	74	25 7	31 6	7 5	796	4	Lift	1.5	✓	–
Livingstone	5.8	9.2	2.25	53	19 0	30 2	7 5	570	4	Lift	1.5	✓	–
Kenney	4.8	6.0	2.1	28	15 9	19 8	6 11	301	4	Lift	1.5	✓	–
Mursell	4.8	5.6	2.1	26	15 9	18 4	6 11	279	4	Lift	1.5	✓	–
Collier	4.8	5.6	2.1	26	15 9	18 4	6 11	279	4	Lift	1.5	✓	–



For information and bookings call:

London

T +44 (0)20 7845 8680

F +44 (0)20 7845 8681

E [londonmeetings@radisson.com](mailto:londonmeetings@radisson.com)

Manchester

T +44 (0)161 835 9929

F +44 (0)161 835 9979

E [rehmanchestermeetings@radisson.com](mailto:rehmanchestermeetings@radisson.com)

Heathrow

T +44 (0)20 8757 7903

F +44 (0)20 8757 7904

E [htrwcb@radisson.com](mailto:htrwcb@radisson.com)

or visit [www.radissonedwardian.com](http://www.radissonedwardian.com)