

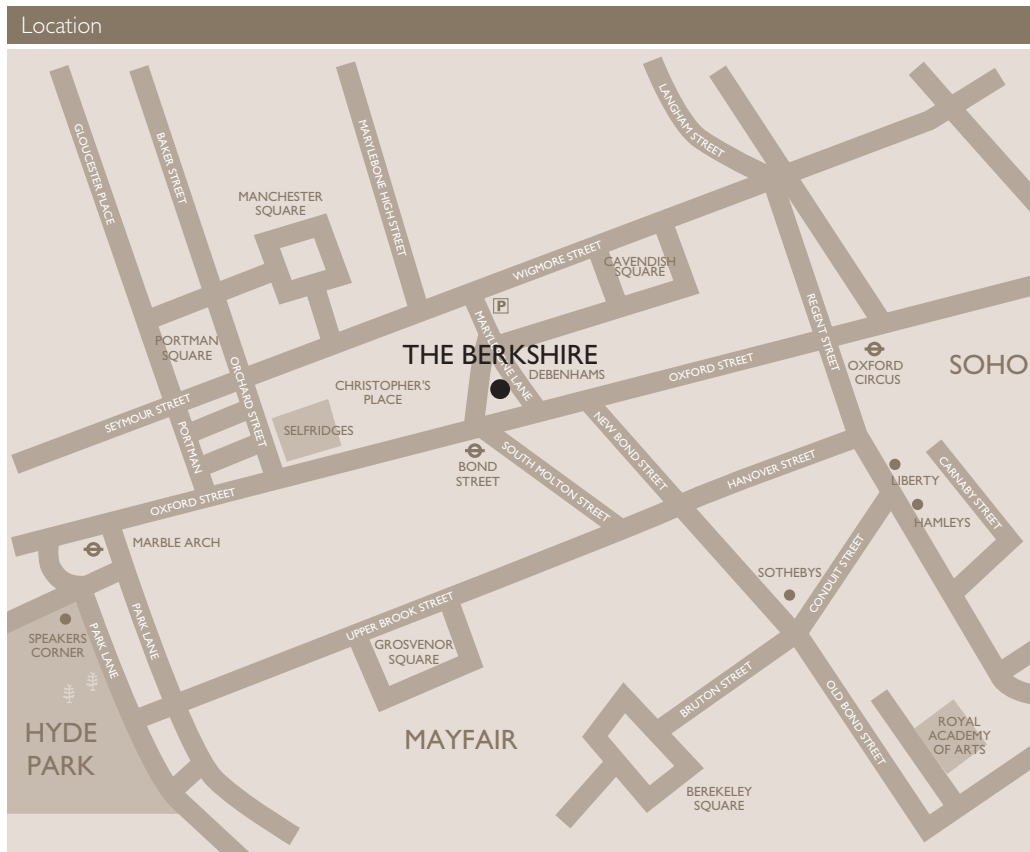

berkshire planning guide



**Contact information**

Radisson Edwardian Berkshire Hotel  
**★★★★ DELUXE**  
 350 Oxford Street  
 London W1N 0BY  
 Telephone: +44 (0)20 7629 7474  
 Facsimile: +44 (0)20 7629 8156  
 Email: resberk@radisson.com

Conference & private dining  
 Telephone: +44 (0)20 7845 8613  
 Facsimile: +44 (0)20 7666 3665  
 Email: berkcb@radisson.com  
 www.radissonedwardian.com

This is a working document that gives you all the practical details, plans and space to make notes as you plan for your event. It is also makes it easy to discuss your event accurately over the telephone. We hope you find it valuable.

**Accommodation**

147 bedrooms:  
 2 Suites; 32 Deluxe; 14 Single Deluxe;  
 12 Kings; 53 Doubles; 23 Twins; 11 Singles;  
 8 floors; 2 lifts accessing all floors

**Facilities**

Air-conditioning  
 B&O televisions  
 Express check out  
 High speed broadband internet access  
 In-room safe  
 Mini bar  
 Mobile phone hire  
 Personal phone number with voicemail  
 Personalised viewing/listening  
 - films & music  
 Trouser press/iron

Deluxe rooms also offer  
 Kingsize or queensize bed  
 Work area/desk  
 Bathrobe and slippers  
 Extra pillows

**Hotel services**

State of the art business centre.  
 Wireless connectivity in public areas.  
 Concierge can arrange sightseeing tours;  
 theatre and concert tickets; flowers; car hire.  
 Babysitting available on request.  
 Valet service available for laundry.

**Dining**

Ascots restaurant & bar  
 Ascots lobby bar

**Conference and private dining**

2 meeting rooms  
 Maximum capacity: 35

**Nearest underground station**

Bond Street; Central Line and Jubilee Line

**Nearest car park**

**P** Welbeck Street  
 (Entrance on Marylebone Lane)  
 07.00-22.00 Monday-Friday  
 08.00-21.00 Saturday  
 09.00-19.00 Sunday

**Airports**

	Approx miles	Approx minutes
Gatwick	29	60
Heathrow	18	40
London City	10	30
Luton	35	60
Stansted	36	60

For places of interest please refer to map.

Guideline capacities

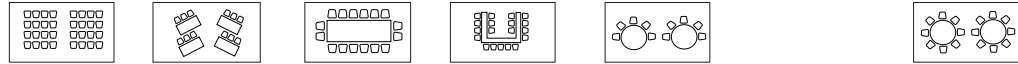

Function suites & rooms	Theatre	Classroom	Boardroom	U-shape	Cabaret	Reception	Lunch/dinner	Dinner dance
Sandhurst	-	-	14	-	-	-	14	
Sonning	35	16	20	16	12	40	20	

Dimensions & access

Details and measurements	Length m	Width m	Ceiling height m	Area square m	No. 13amp sockets	Phone points	Delegate access	Access door size h x w m	Air Con.	Natural daylight
Sandhurst	6.3	6.3	2.6	30	12	7	Stairs/lift	2.0 x 0.75	✓	✓
Sonning	7.7	7.0	2.6	35	20	16	Stairs/lift	2.0 x 0.75	✓	✓

Seventh Floor

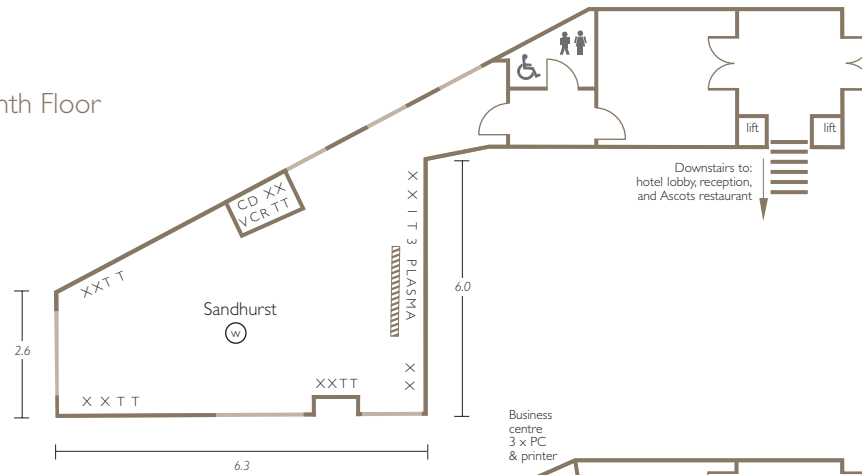

Eighth Floor

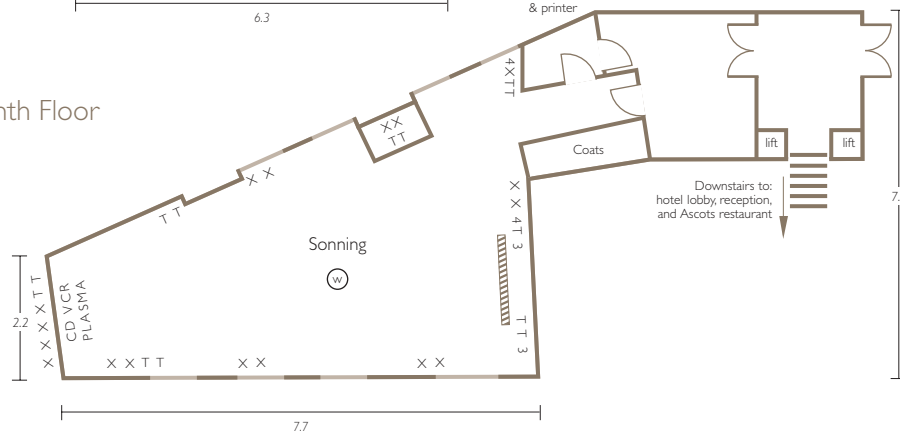

**Key**

- T = Telephone
- X = 13 amp socket
- A = TV aerial
- Windows
- CD Multi region CD
- VCR VCR player
- PLASMA 42" plasma
- 5' ceiling mount screen
- W Wireless connectivity
- I Internet point
- 3 US socket



For information and bookings call:

London  
T +44 (0)20 7845 8680  
F +44 (0)20 7845 8681  
E [londonmeetings@radisson.com](mailto:londonmeetings@radisson.com)

Manchester  
T +44 (0)161 835 9929  
F +44 (0)161 835 9979  
E [rehmanchestermeetings@radisson.com](mailto:rehmanchestermeetings@radisson.com)

Heathrow  
T +44 (0)20 8757 7903  
F +44 (0)20 8757 7904  
E [htrwcb@radisson.com](mailto:htrwcb@radisson.com)

or visit [www.radissonedwardian.com](http://www.radissonedwardian.com)